

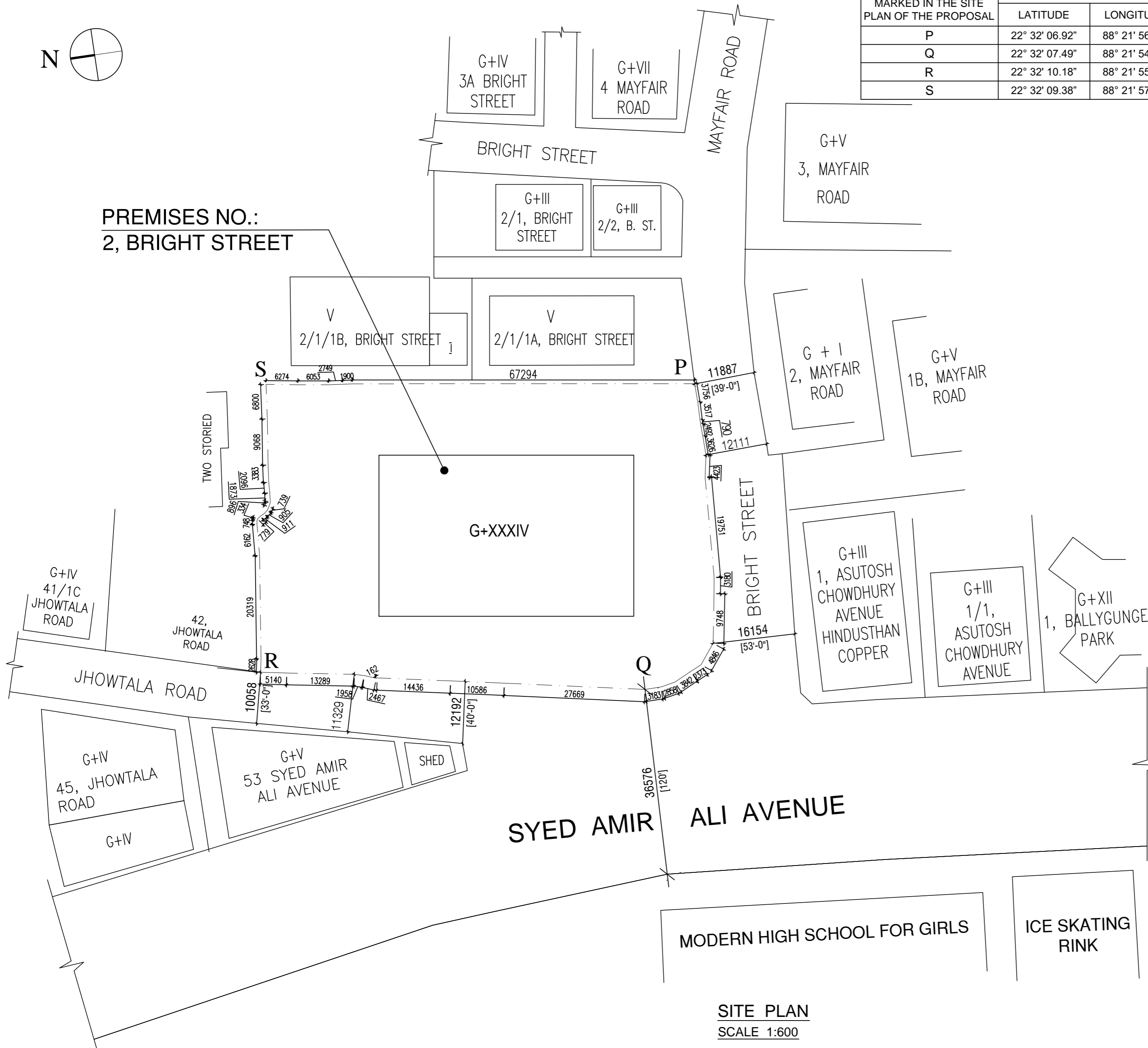

REFERENCE POINTS MARKED IN THE SITE PLAN OF THE PROPOSAL	CO-ORDINATE IN WGS84		SITE ELEVATION (AMSL)
	LATITUDE	LONGITUDE	
P	22° 32' 06.92"	88° 21' 56.56"	6.0 M.
Q	22° 32' 07.49"	88° 21' 54.48"	6.0 M.
R	22° 32' 10.18"	88° 21' 55.51"	6.0 M.
S	22° 32' 09.38"	88° 21' 57.38"	6.0 M.

PLAN FOR PROPOSED G + XXXIV STORED RESIDENTIAL PRE CERTIFIED GOLD GREEN BUILDING OF HEIGHT 141.200 M. AT PREMISES NO. 2 BRIGHT STREET, KOLKATA - 700019, WARD NO.- 65, BOROUGH - VII, P.S.- KARAYA , U/S - 393A OF K.M.C. ACT 1980 & COMPLYING THE NEW AMENDMENT OF BUILDING RULE 2009.

PREMISES NO.:  
2, BRIGHT STREET



SITE PLAN  
SCALE 1:600

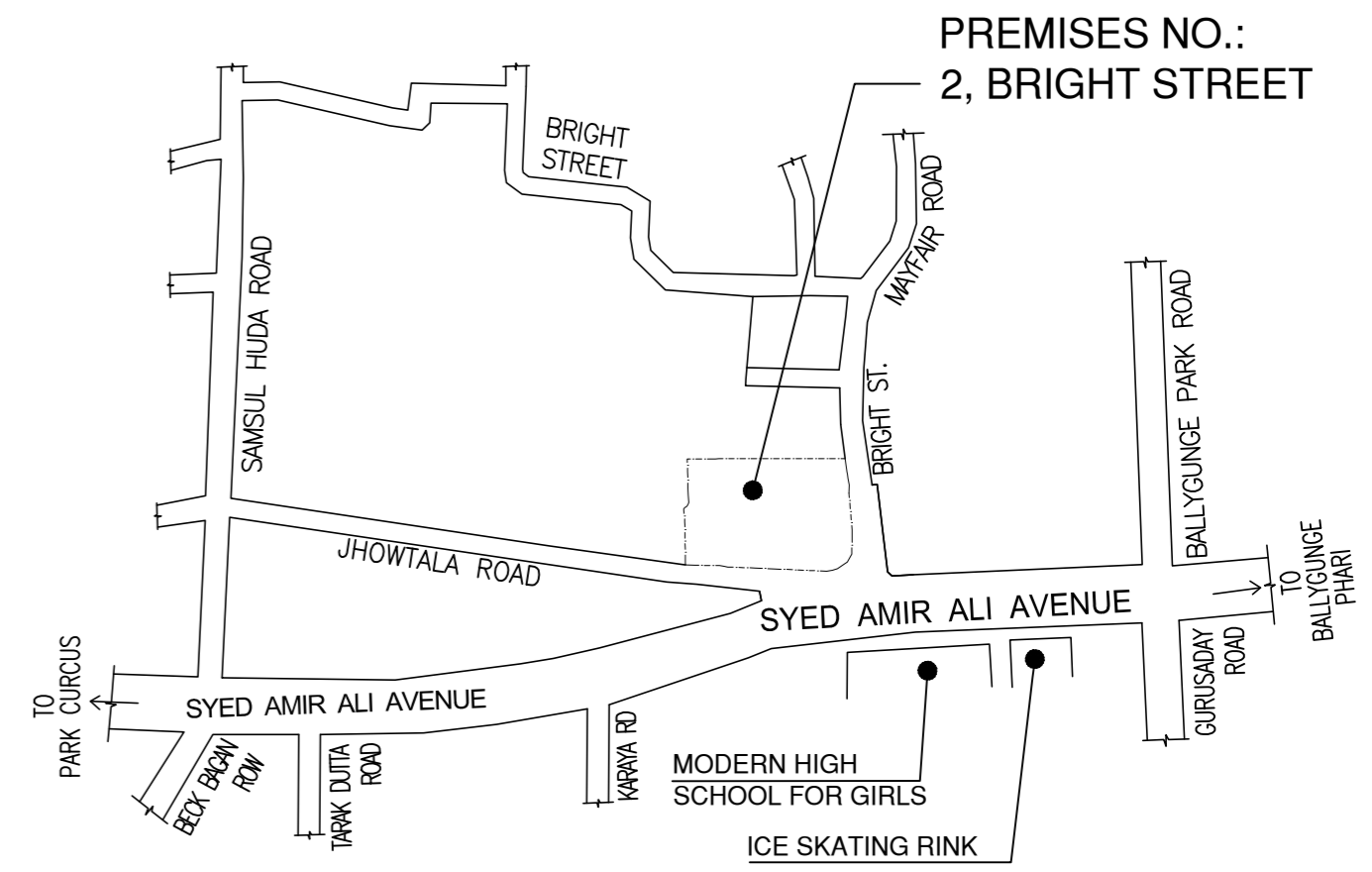

LOCATION PLAN  
SCALE 1:4000

OWNERS DECLARATION

I DO HEREBY DECLARE WITH FULL RESPONSIBILITY THAT I SHALL ENGAGE ARCHITECT, E.S.E. & G.T.E. DURING CONSTRUCTION. I SHALL FOLLOW THE INSTRUCTIONS OF ARCHITECT, E.S.E. & G.T.E. DURING CONSTRUCTION OF THE BUILDING (AS PER B.S.PLAN). K.M.C. AUTHORITY WILL NOT BE RESPONSIBLE FOR STRUCTURAL STABILITY OF THE BUILDING AND ADJOINING STRUCTURES. IF ANY SUBMITTED DOCUMENTS ARE FOUND TO BE FAKE, THE K.M.C. AUTHORITY WILL REVOKE THE SANCTION PLAN. THE CONSTRUCTION OF WATER RESERVOIR WILL BE UNDER TAKEN UNDER THE GUIDANCE OF E.S.E. AND ARCHITECT BEFORE STARTING OF BUILDING FOUNDATION WORK. DURING INSPECTION PLOT WAS IDENTIFIED BY ME.

MAHENDRA JAIN  
(Director of Arjavv Builder Private Limited)  
Constituted Attorney of  
SAUMISH CHANDRA ROY  
NAME OF SIGNATORY / APPLICANT

CERTIFICATE OF STRUCTURAL ENGINEER.

THIS IS TO CERTIFY THAT THE STRUCTURAL DESIGN AND SUPER STRUCTURE OF THE BUILDING HAS BEEN MADE BY ME CONSIDERING ALL POSSIBLE LOADS INCLUDING THE SEISMIC LOAD AS PER THE NATIONAL BUILDING CODE OF INDIA AND CERTIFIED THAT IT IS SAFE AND STABLE IN ALL RESPECTS. WE DO, HEREBY, ALSO UNDERTAKE THAT DURING EXECUTION OF THE WORK ALL PRECAUTIONARY MEASURES WILL BE TAKEN BY US IN RESPECT OF SAFETY AND STABILITY OF THE ADJOINING STRUCTURE AND PROPERTIES.

SANJIV J. PAREKH (ESE-1/104) SANJIB GUHA / ESR-88/16(I)  
NAME OF STRUCTURAL ENGINEER NAME OF STRUCTURAL REVIEWER

CERTIFICATE OF GEO-TECHNICAL ENGINEER:

UNDERSIGNED HAS INSPECTED THE SITE AND CARRIED OUT SOIL INVESTIGATION. IT IS CERTIFIED THAT THE EXISTING SOIL OF THE SITE IS ABLE TO CARRY THE LOAD COMING FROM THE PROPOSED CONSTRUCTION AND THE FOUNDATION SYSTEM PROPOSED HEREIN IS SAFE AND STABLE IN ALL RESPECT FROM GEO-TECHNICAL POINT OF VIEW.

JISHNU PAL, G.T.E. - 1/32  
NAME OF GEO-TECH. ENGINEER

CERTIFICATE OF ARCHITECT

I DO HERE BY CERTIFY WITH FULL RESPONSIBILITY THAT THE BUILDING PLAN HAS BEEN DRAWN UP AS PER K.M.C. BUILDING RULE - 2009 AS AMENDED FROM TIME TO TIME. THAT THE WIDTH OF THE ABUTTING ROAD CONFORM WITH THE PLAN AND IT IS A BUILDABLE SITE NOT A TANK OR A FILLED UP TANK. THE SITE PLAN, KEY PLAN AGREES WITH THE SITE, THE PLOT IS DEMARCATED BY BOUNDARY WALLS & MEASUREMENTS TALLY WITH THE REGD. DEED PLAN. THE EXISTING STRUCTURE AS SHOWN FULLY OCCUPIED BY OWNERS AS PER OWNERS UNDERTAKING.

JAY PRAKASH BHARAT KUMAR AGRAWAL  
REGN. NO. - CA/86/10098  
NAME OF ARCHITECT

ARCHITECTS  
AGRAWAL & AGRAWAL  
BARODA KOLKATA

SHEET NO.	SCALE	DATE	DEALT	CHECKED
CA-1.3	1 : 100	03.02.2024		

BUILDING PERMIT NO. 2023070217  
DATE :12.02.2024  
VALID UPTO :11.02.2029

DIGITAL SIGNATURE OF ASSISTANT ENGINEER (CIVIL)  
BUILDING DEPT./BOROUGH NO.VII / K.M.C

DIGITAL SIGNATURE OF EXECUTIVE ENGINEER (CIVIL)  
BUILDING DEPT./BOROUGH NO.VII / K.M.C

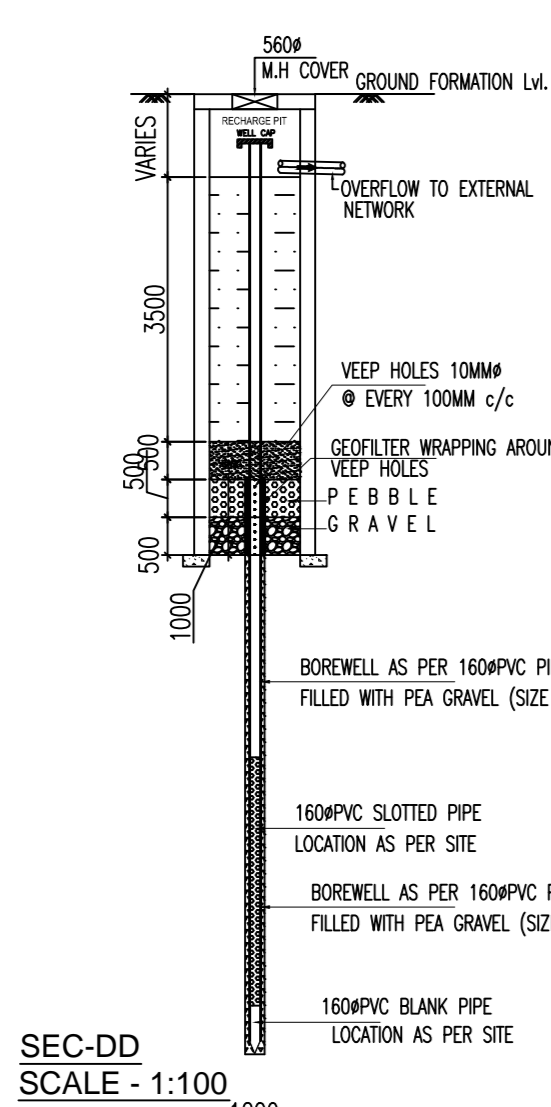

SEC-DD  
SCALE - 1:100  
PLAN OF R.P.  
SCALE - 1:100

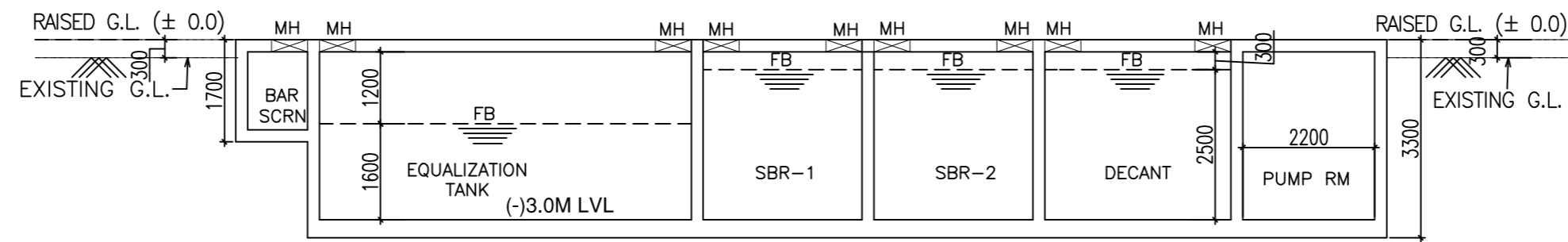

SECTION - CC  
SCALE 1:100

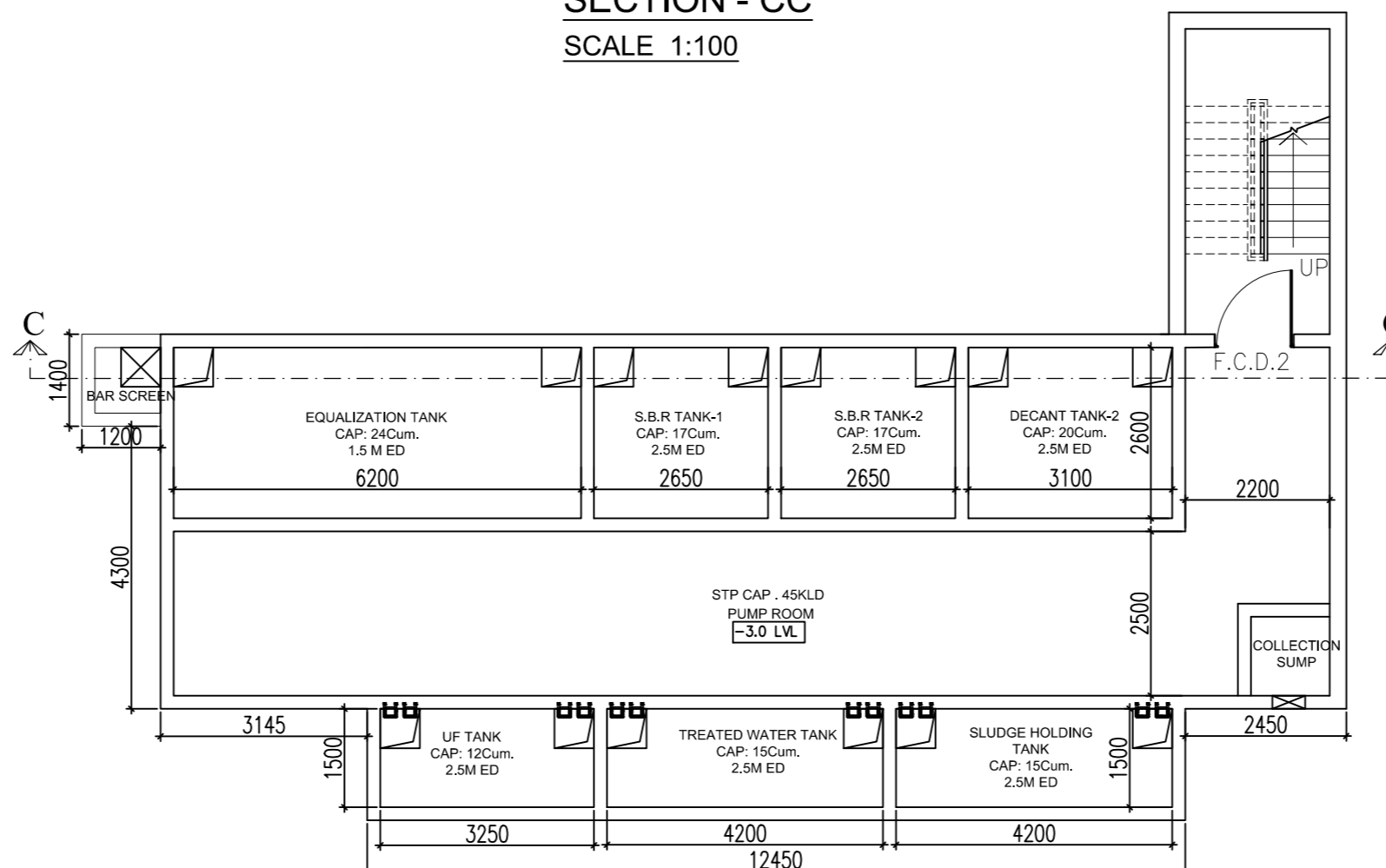

DETAILS OF S.T.P.  
SCALE - 1:100

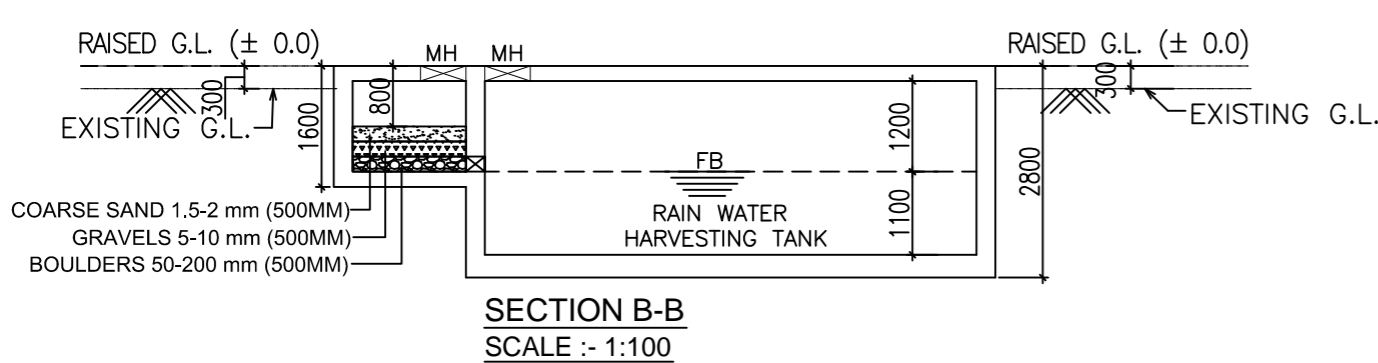

SECTION B-B  
SCALE :- 1:100

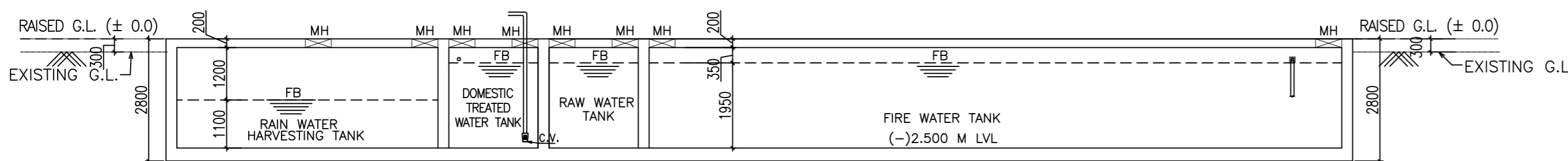

SECTION A-A  
SCALE :- 1:100

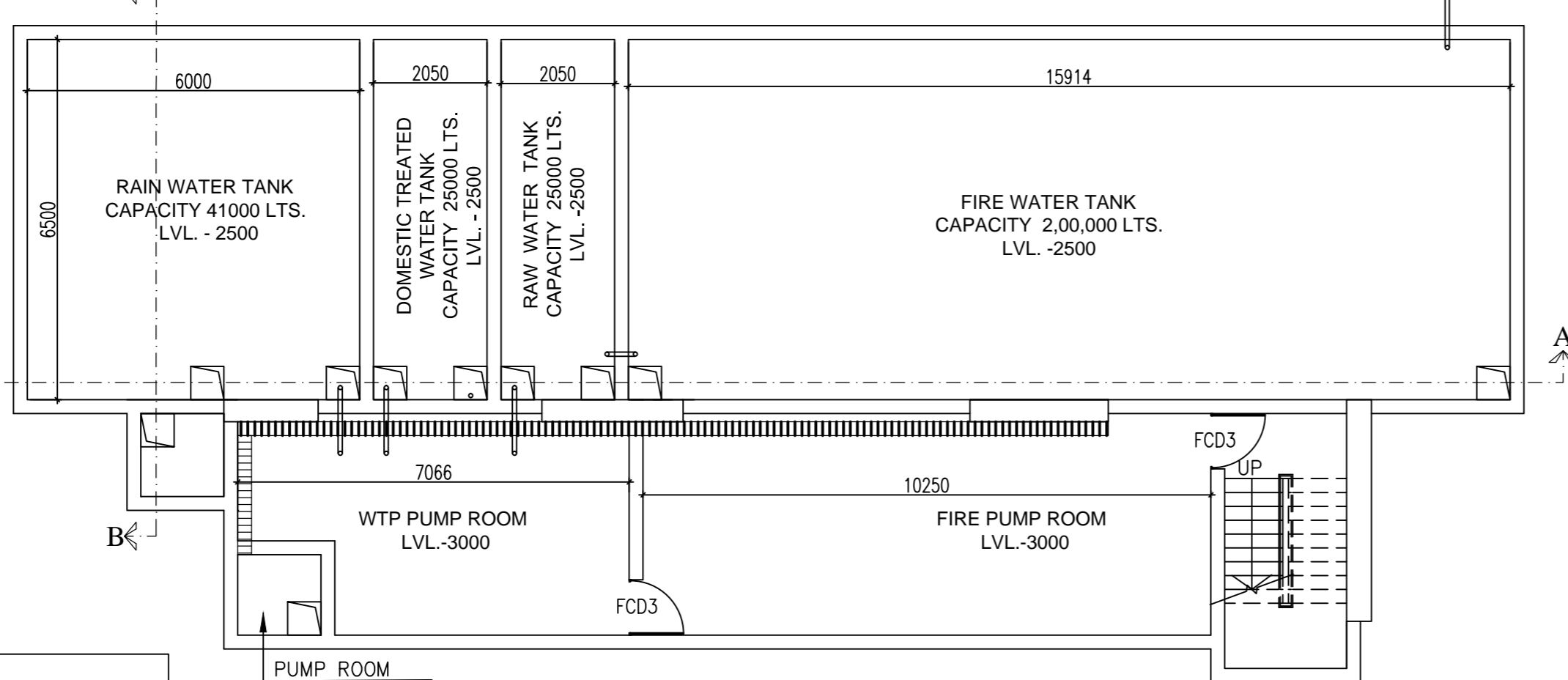

DETAIL OF FIRE PUMP ROOM, U.G.W.R.&  
R.W.H.T. SCALE - 1:100

NOTE:-  
ALL LEVELS ARE WRITTEN IN THIS DRG.,  
CONSIDERING RAISED G.L. AS ±0.0  
RAISED G.L. IS +300 FROM ROAD CROWN LVL.